



**EMBI**

SOCIAL HOUSINGFG PROJECT

---

**BURKINA FASO**

**CLIENTS REQUIREMENT****SITE PLAN - Project I**

- A. One Storey Floor adjacent houses "type 1" will be implemented on 94 m x 16 m sized plots
- B. One Storey Floor adjacent houses "type 1" will be implemented on 120 m x 16 m sized plots
- C. One Storey Floor adjacent houses "type 2" will be implemented on 94 m x 18m sized plots
- 8604 adjacent houses of type 1 on 303 plots
  - 3600 adjacent houses of type 2 on 180 plots
- D. Social Facilities for every 4028 adjacent houses

**TABLE OF AREAS-Project I**

PARCEL TYPE	TYPE OF HOUSES	NUMBER OF HOUSES	NUMBER OF BLOCKS	NUMBER OF FLOORS	GROSS FLOOR AREA (each house)	GROSS BLOCK AREA	TOTAL GROSS M2 OF EACH TYPE
A	Type1(1+1)	8604	2151	1	35.90 m <sup>2</sup>	143.90 m <sup>2</sup>	305221.9 m <sup>2</sup>
B	Type2(2+1)	3600	900	1	61.88 m <sup>2</sup>	246.33 m <sup>2</sup>	221697 m <sup>2</sup>
<b>TOTAL</b>							<b>526918.9m<sup>2</sup></b>



# BURKINA FASO

LAND AREA 162 ha

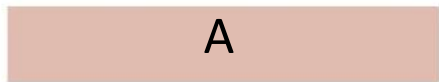
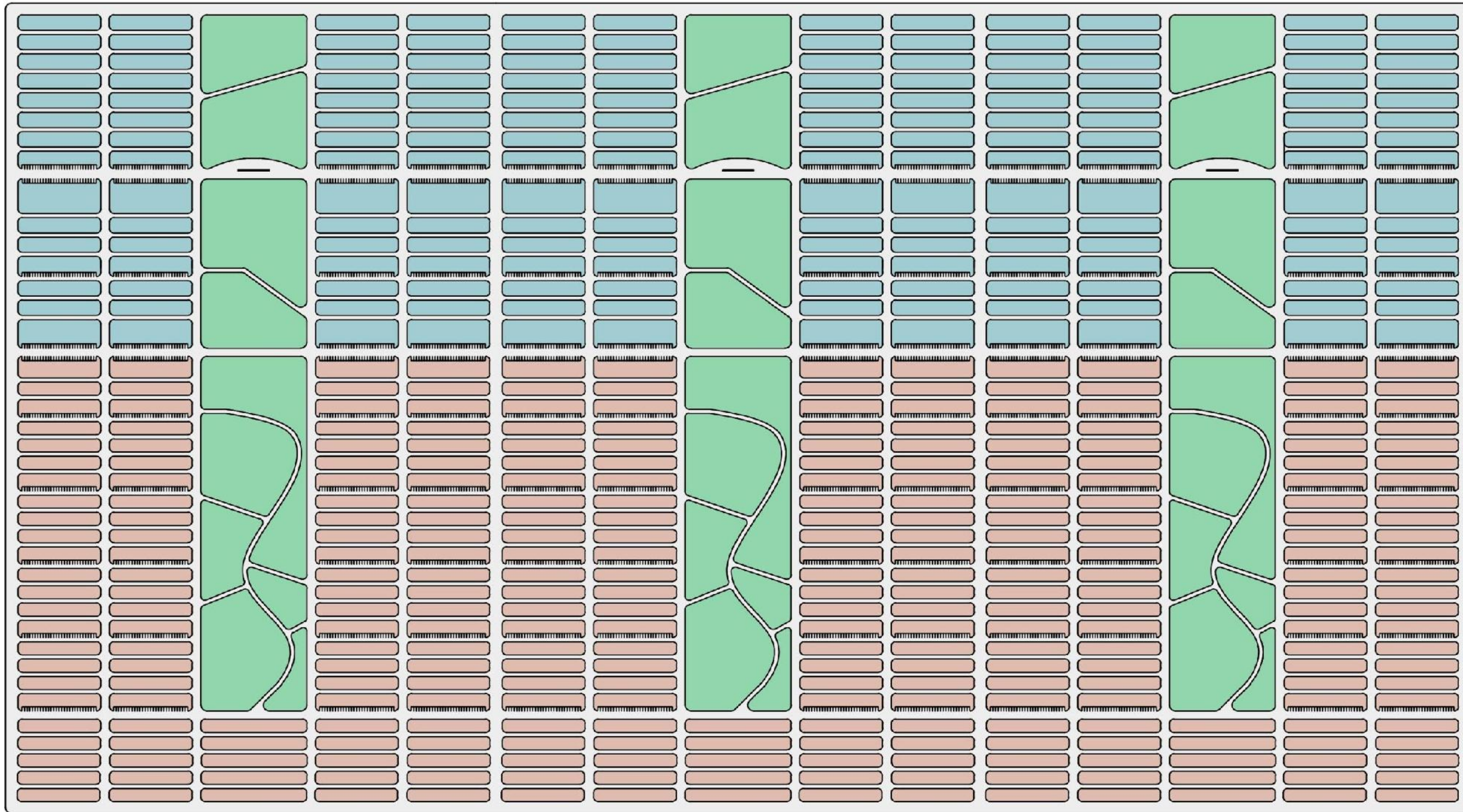

8604 Adjacent Houses of Type 1 on 303 Plots

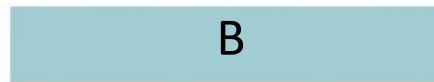

3600 Adjacent Houses of Type 2 on 180 Plots



Social Facilities



# BURKINA FASO





# BURKINA FASO

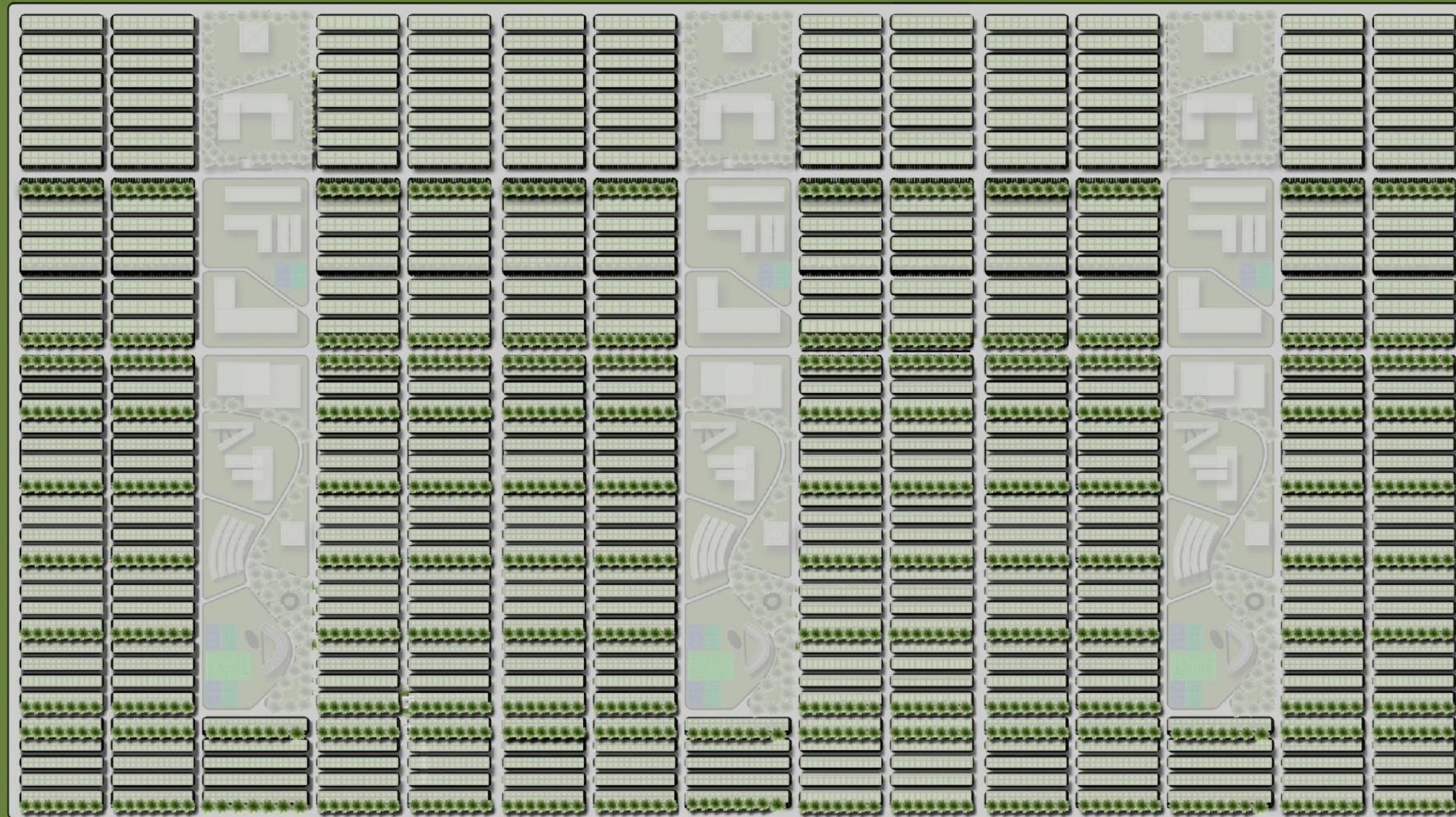

2034 HOUSING UNITS	2034 HOUSING UNITS	2034 HOUSING UNITS	2034 HOUSING UNITS	2034 HOUSING UNITS	2034 HOUSING UNITS
SETTLEMENT UNIT 1	SETTLEMENT UNIT 2	SETTLEMENT UNIT 3	SETTLEMENT UNIT 4	SETTLEMENT UNIT 5	SETTLEMENT UNIT 6

12204 HOUSING UNITS



# BURKINA FASO





# BURKINA FASO

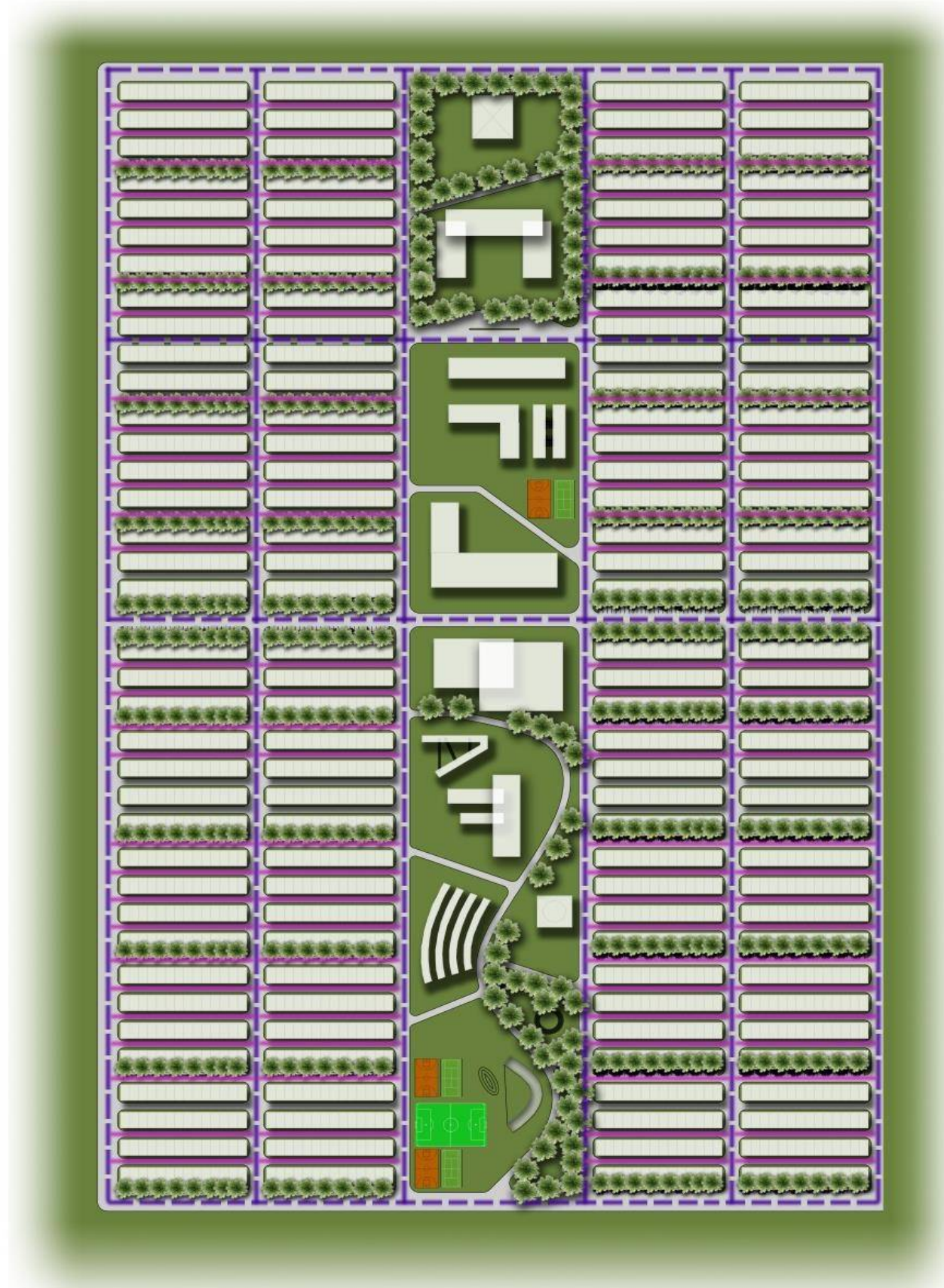

-  MAIN ROAD
-  VEHICLE CIRCULATION



# BURKINA FASO

## WATER DISTRIBUTION SYSTEM

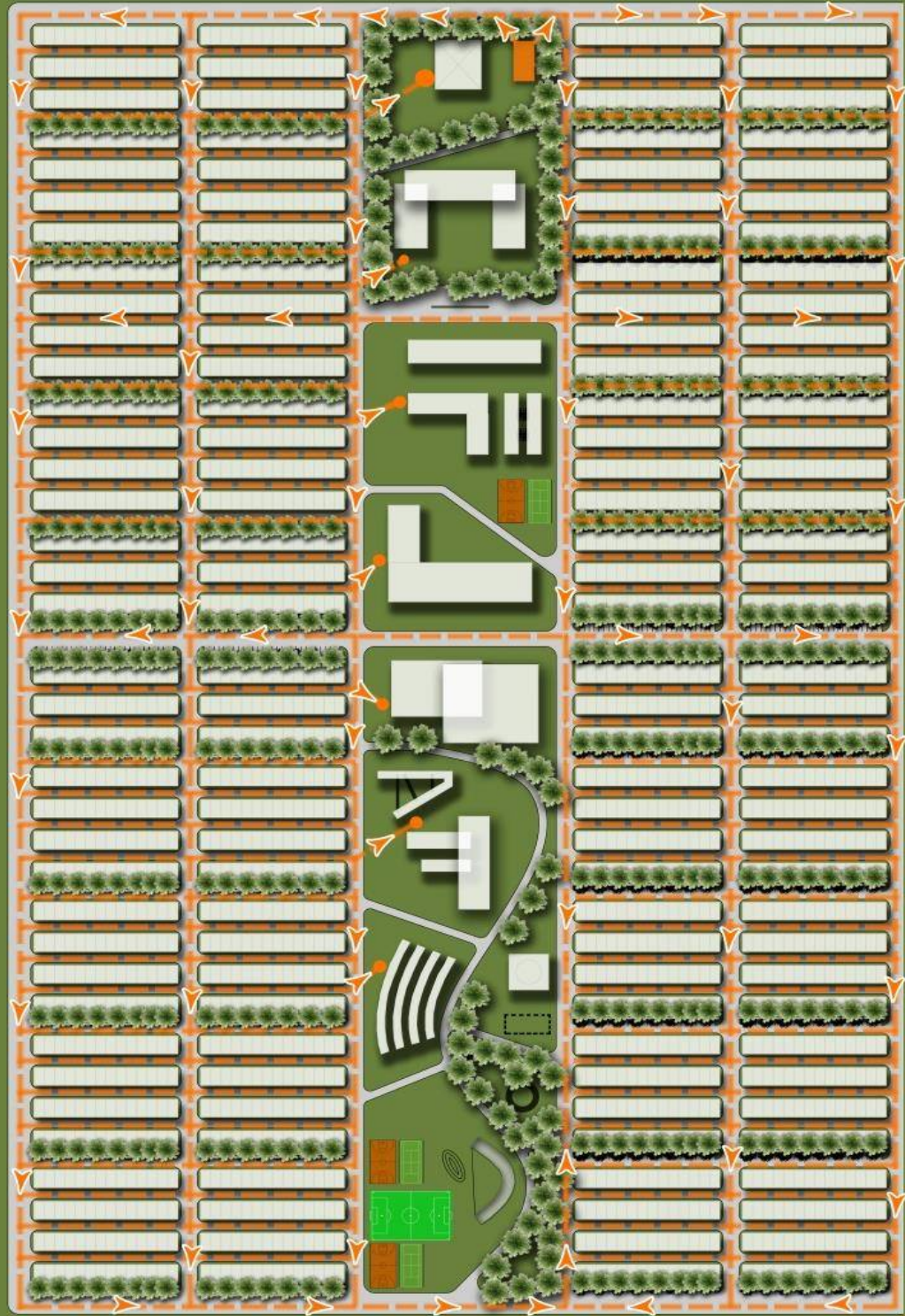

CLEAN WATER DISTRIBUTION SYSTEM



WASTE WATER DISTRIBUTION SYSTEM



# BURKINA FASO

## ENERGY DISTRIBUTION SYSTEM

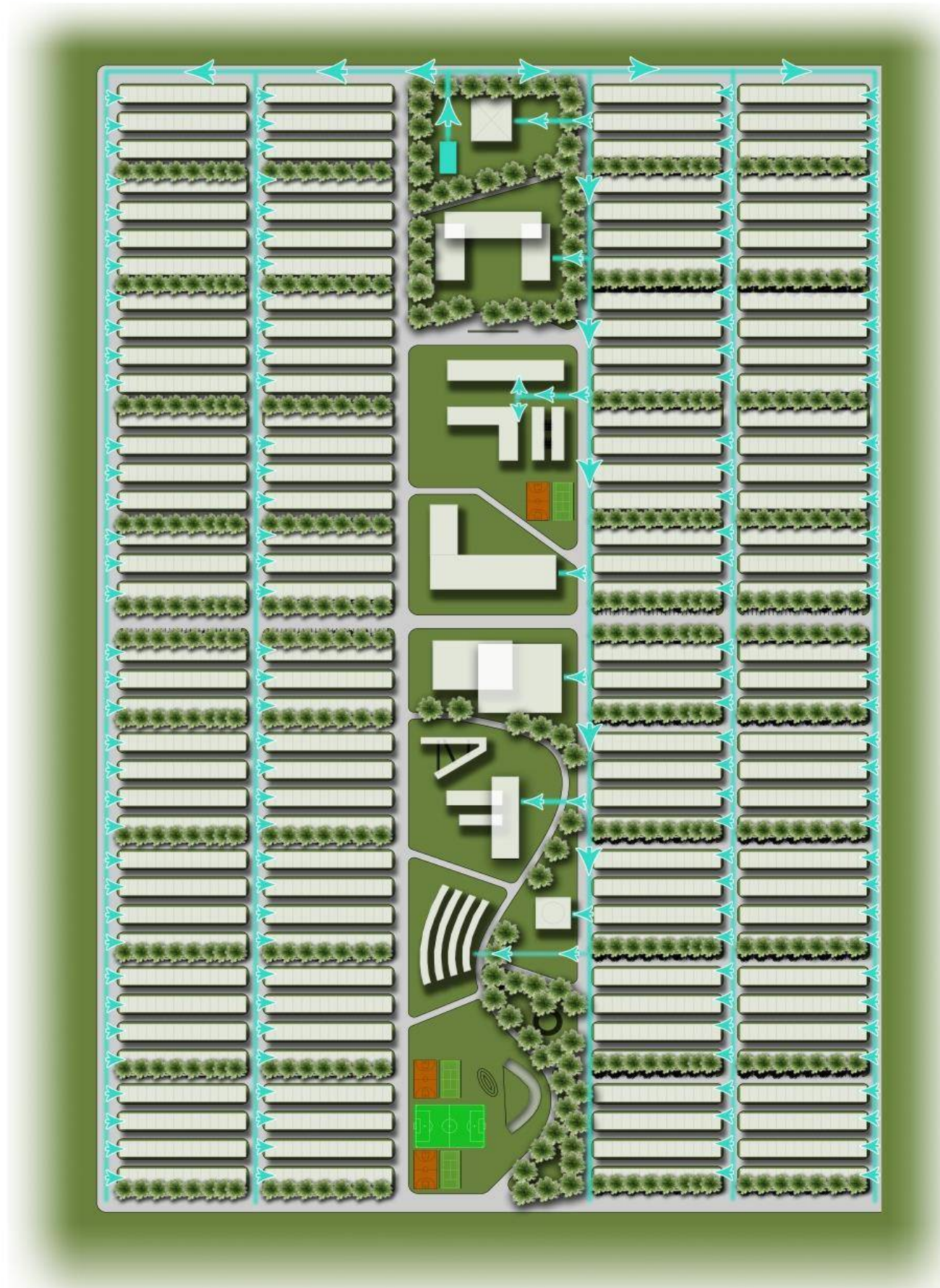



# BURKINA FASO

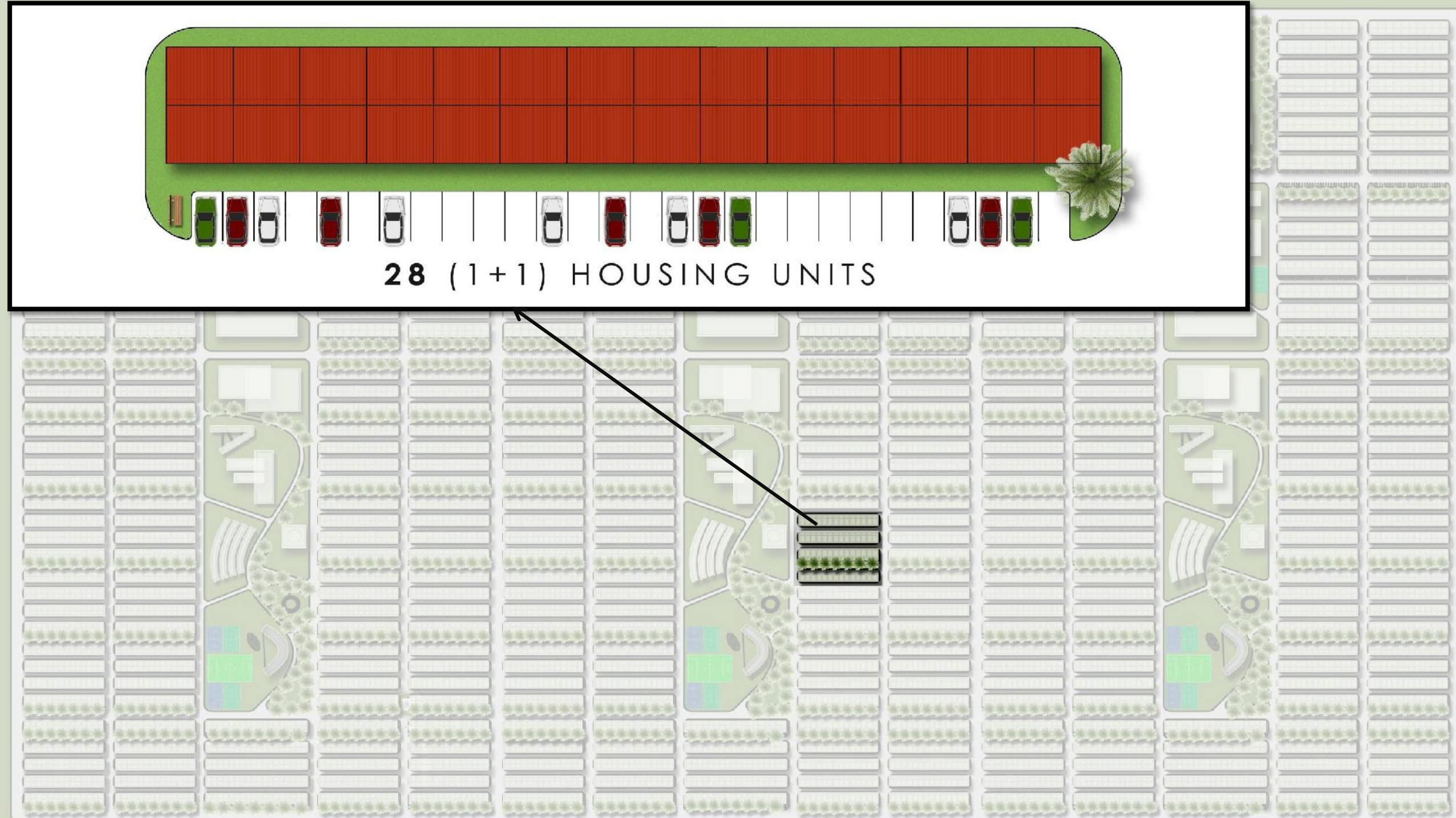



# BURKINA FASO



## TYPE 1 ( 1+1 )

Each House (gross)  
Each House (net)

35.90 m<sup>2</sup>  
31.00 m<sup>2</sup>





# BURKINA FASO

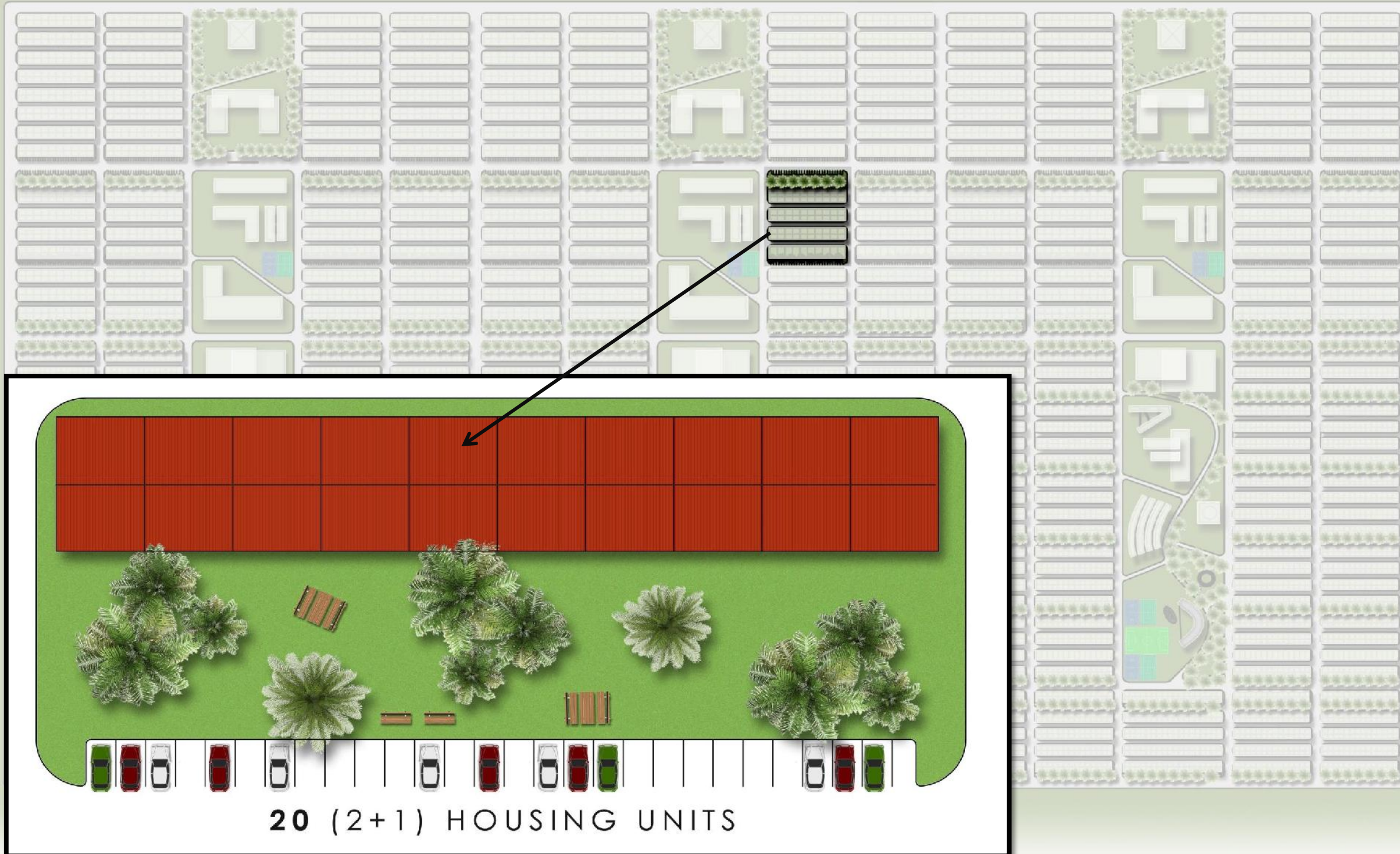



# BURKINA FASO



## TYPE 2 ( 2+1 )

Each House (gross)  
Each House (net)

61.90 m<sup>2</sup>  
57.00 m<sup>2</sup>





# BURKINA FASO





# BURKINA FASO





**CLIENTS REQUIREMENT****SITE PLAN – Project II**

A. One Storey Floor twin houses "type 3" will be implemented on 50 m x 60 m sized plots

- 12000 twin houses of "type 3" on 750 plots

B. Social Facilities for every 2000 twin houses

**TABLE OF AREAS-Project II**

PARCEL TYPE	TYPE OF HOUSES	NUMBER OF HOUSES	NUMBER OF BLOCKS	NUMBER OF FLOORS	GROSS FLOOR AREA (each house)	GROSS BLOCK AREA	TOTAL GROSS M2 OF EACH TYPE
C	Type 3(2+1)	12000	3000	1	61.88	246.33	738990 m2
						TOTAL	738990 m2



# BURKINA FASO

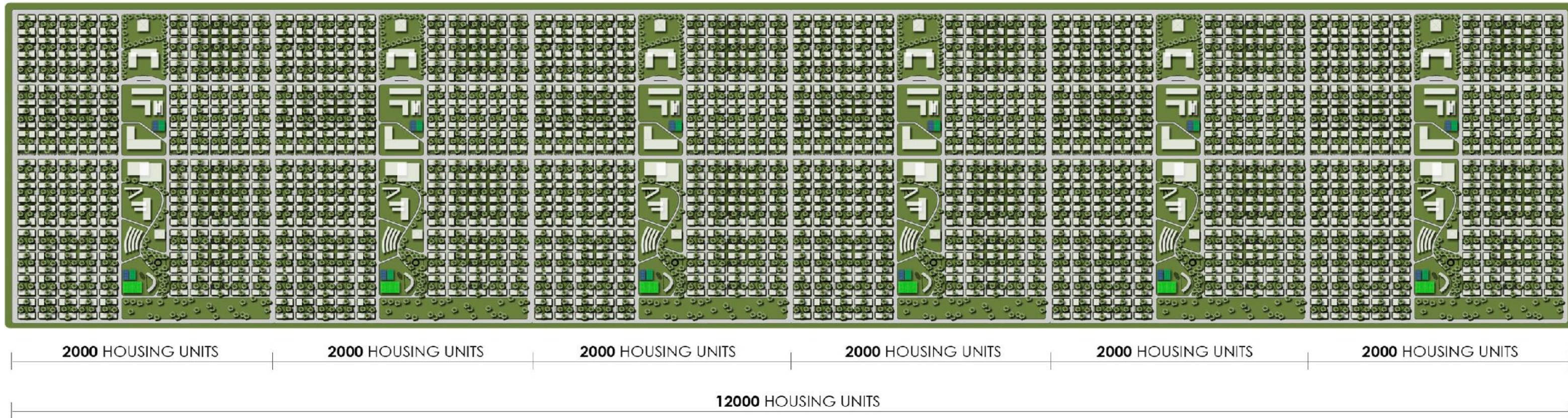



# BURKINA FASO

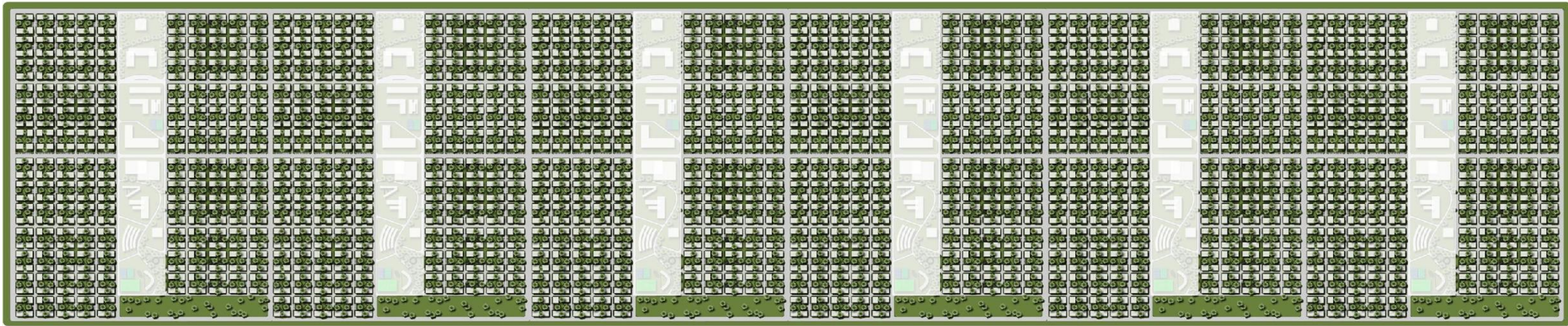



# BURKINA FASO





# BURKINA FASO

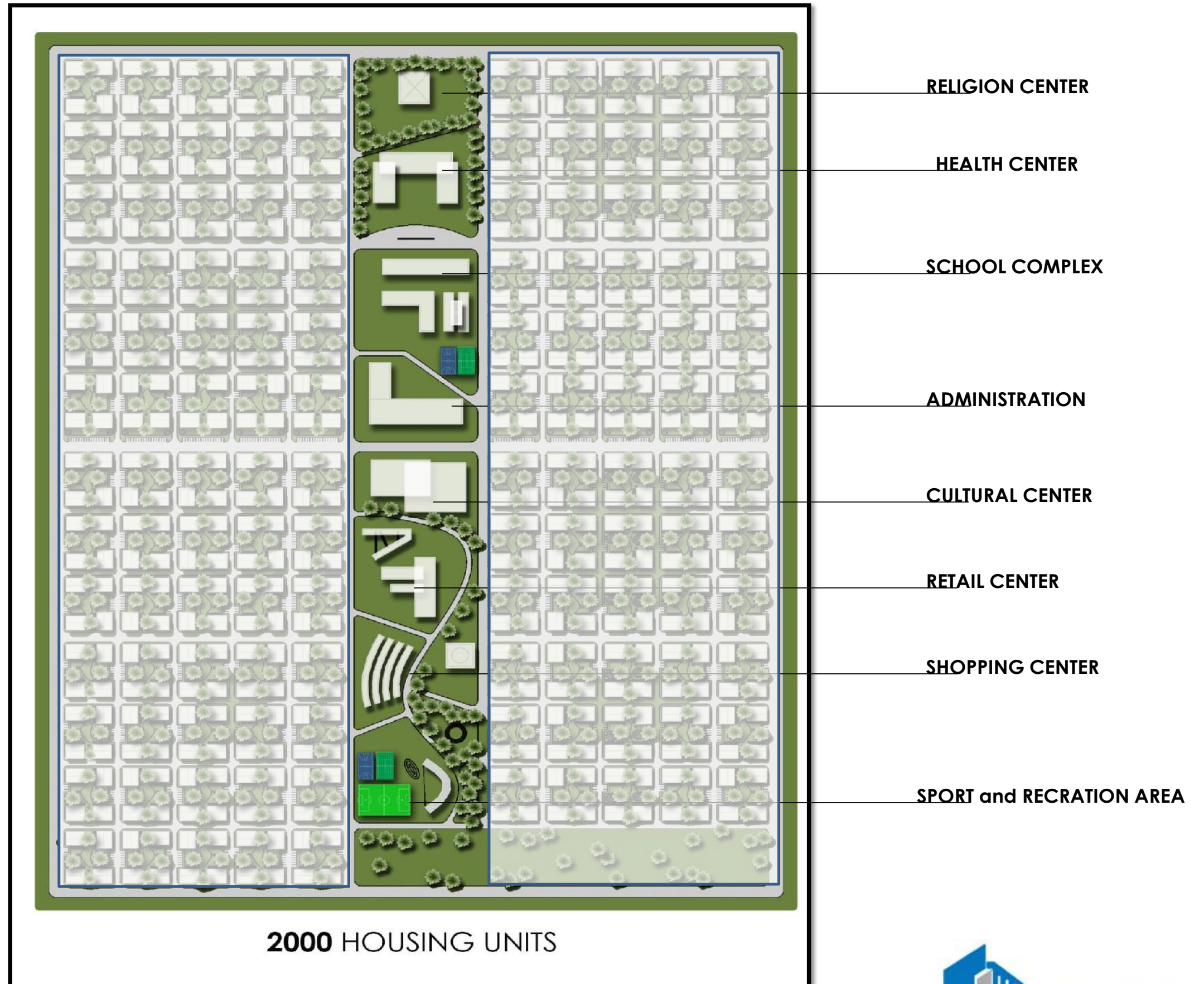



# BURKINA FASO

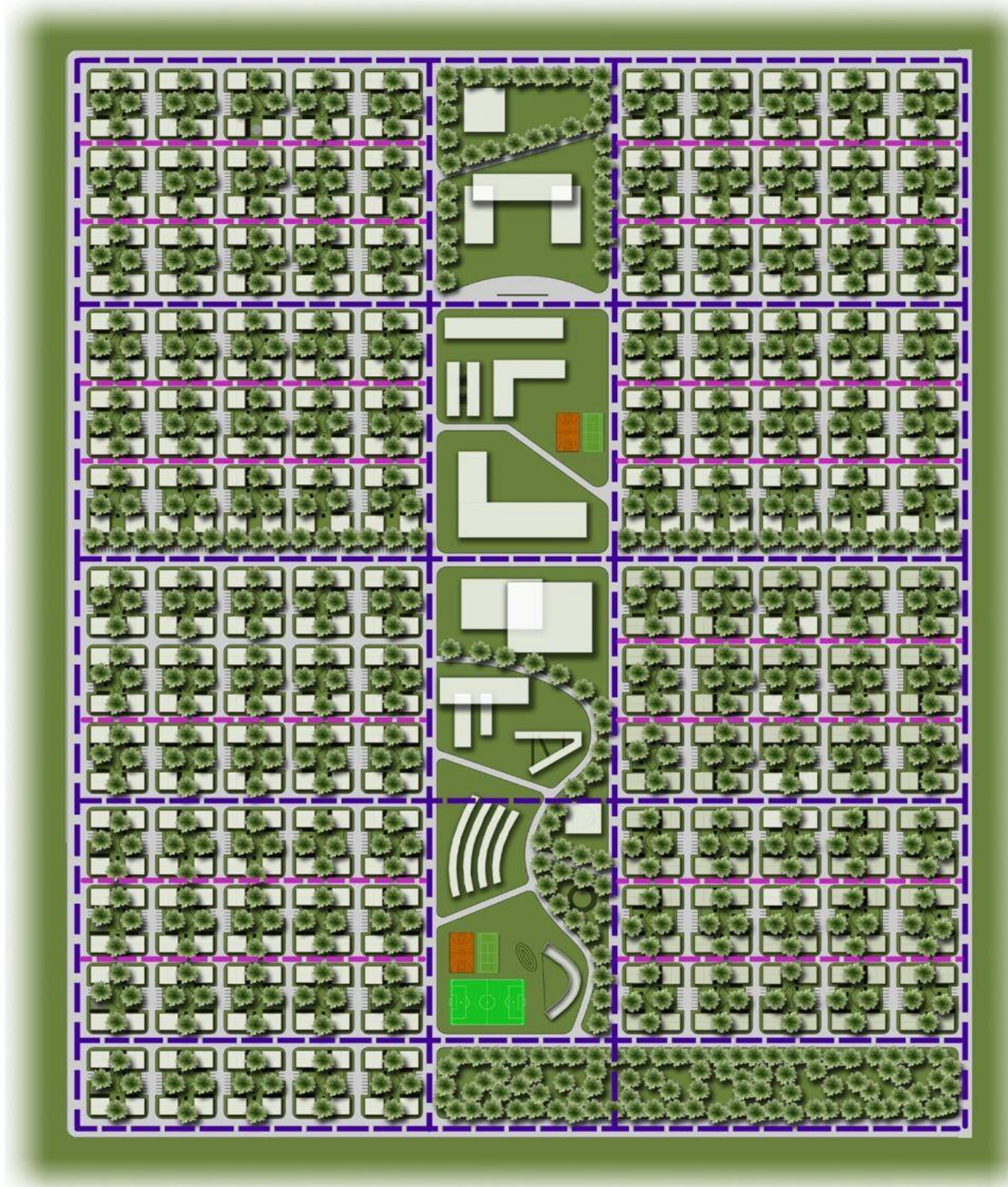

-  MAIN ROAD
-  VEHICLE CIRCULATION



# BURKINA FASO

## WATER DISTRIBUTION SYSTEM

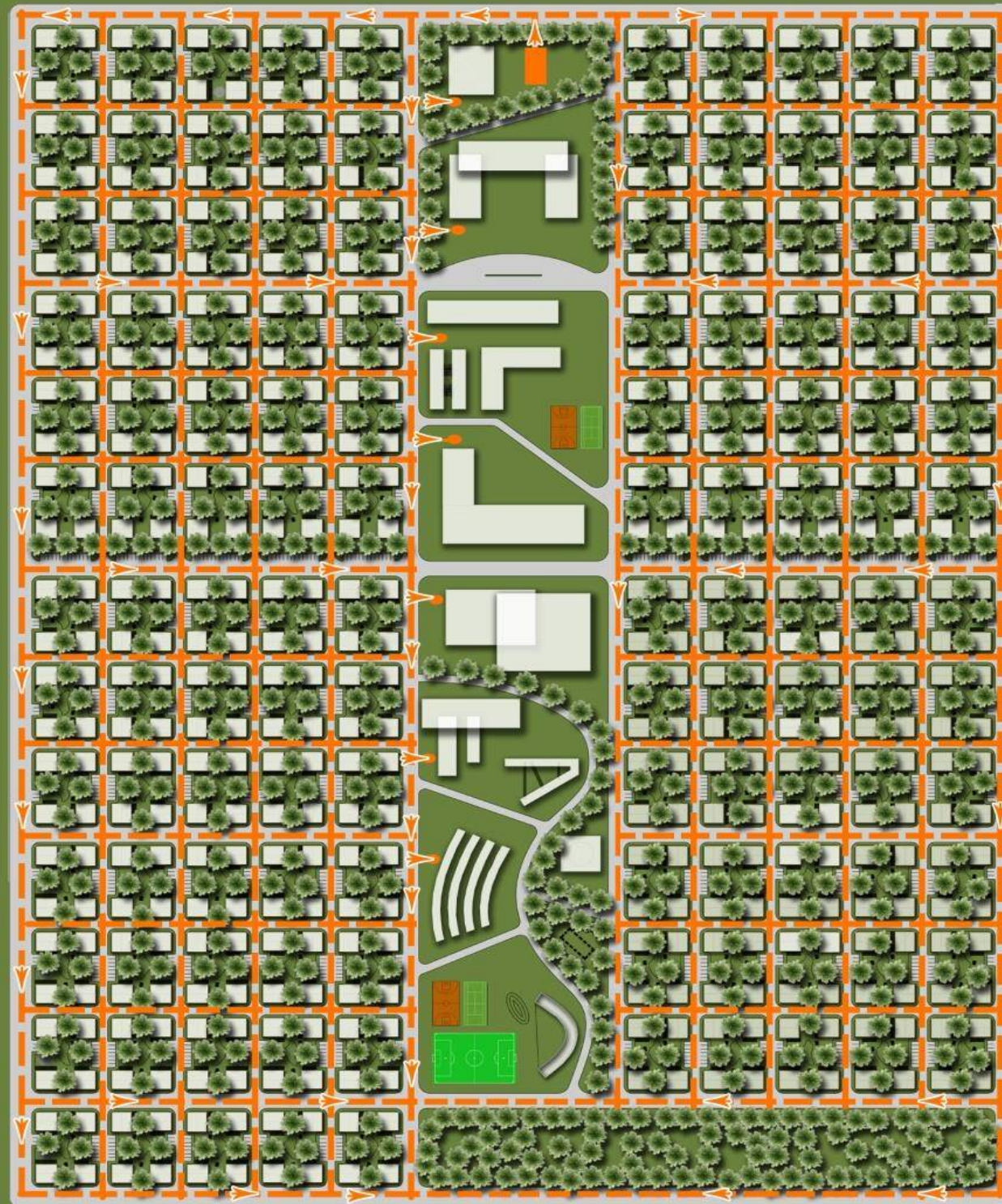

CLEAN WATER DISTRIBUTION SYSTEM

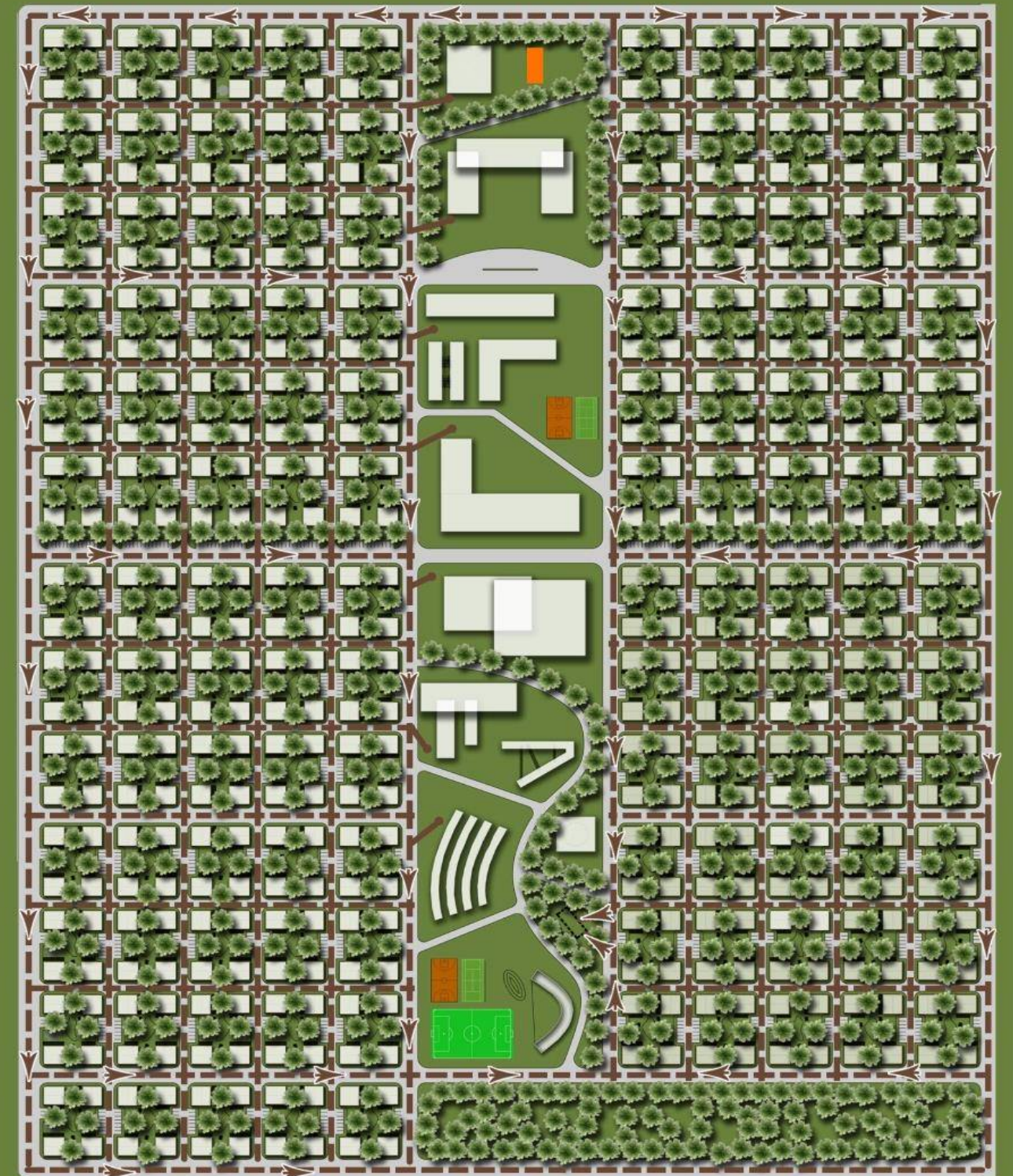

WASTE WATER DISTRIBUTION SYSTEM



# BURKINA FASO

## ENERGY DISTRIBUTION SYSTEM





# BURKINA FASO

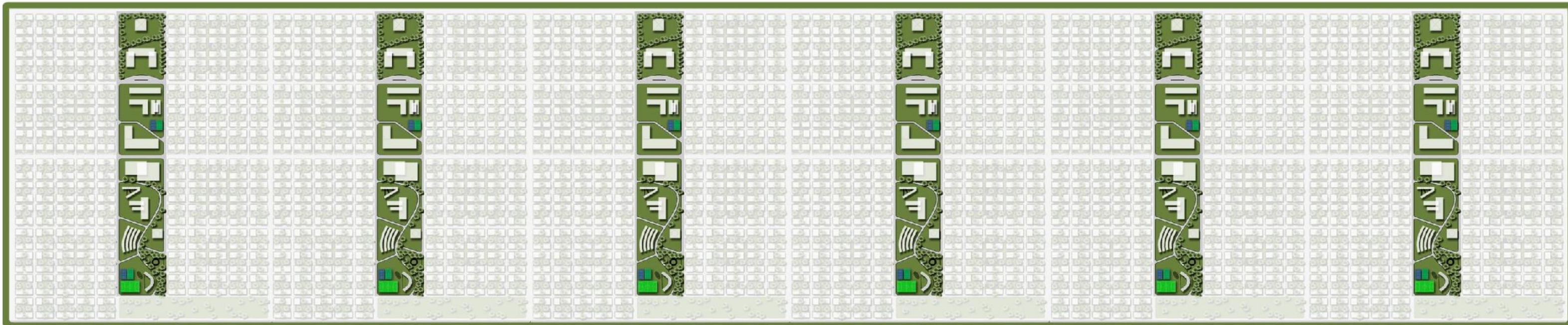



# BURKINA FASO

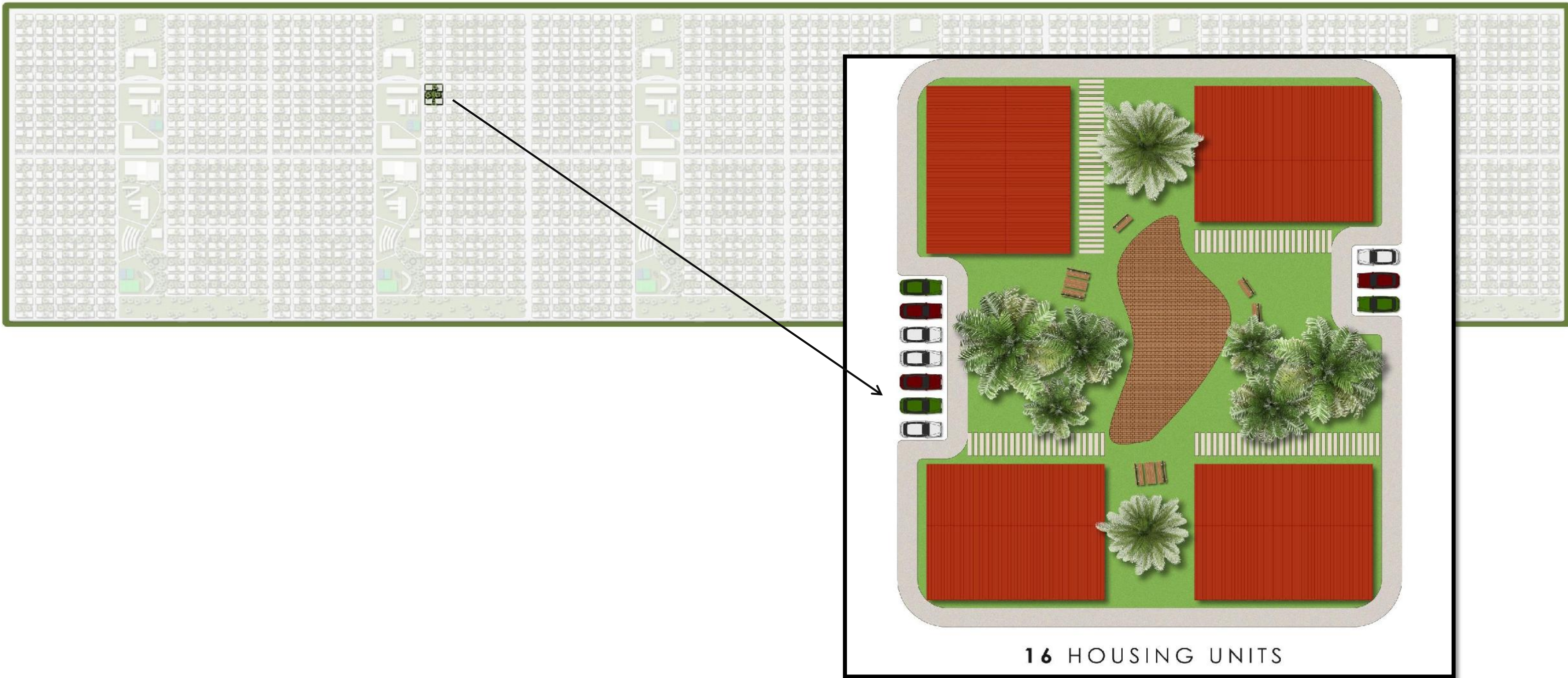



# BURKINA FASO



## TYPE 3 ( 2+1 )

Ground Floor Area(gross)	246.33 m <sup>2</sup>
Each House (gross)	61.90 m <sup>2</sup>
Each House (net)	57.00 m <sup>2</sup>





# BURKINA FASO





# BURKINA FASO







**EMBI**

**Entreprise Moderne De Bâtiment International Burkina**  
**MOBILE: 0022651819646**  
**info@embi-tb.com**  
**<http://www.embi-tb.com>**

